

# Parts Breakdown

Model FP-BR-0014 44532

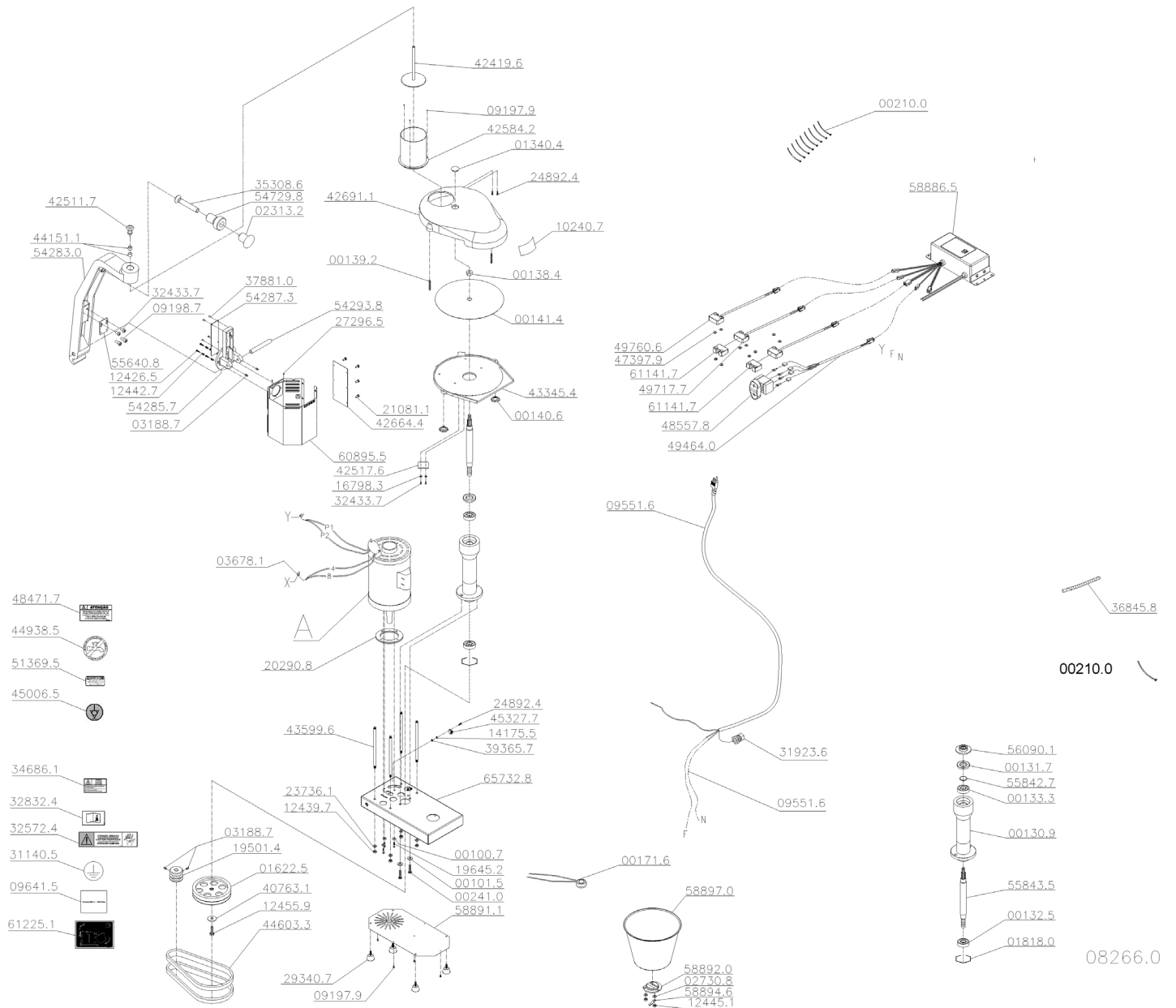

# Parts Breakdown

## Model FP-BR-0014 44532

Item No.	Description	Position	Item No.	Description	Position	Item No.	Description	Position
38109	Skymesen Logo Small for 44532	00047.7	27696	Nylon Cover CN 4478 for 44532	03678.1	38593	Screw M5x6 DIN 84 Stainless Steel for 44532	22996.2
30234	Washer L 1/4x1 6 ZB for 44532	00100.7	AH583	O Ring 31x25x3.5mm for 44532	03750.8	AH593	PFS M4x16 DIN 965 Stainless Steel for 44532	23440.0
30270	Washer L 3 8 ZB for 44532	00101.5	27699	Cramp T 18R Small for 44532	04203.0	AH594	ARR.L.A13 DIN 125 Stainless Steel for 44532	23736.1
AH560	Double Bearing (Primer) for 44532	00130.9	38089	Pre Isolating Terminal for 44532	04285.4	67035	Screw M4x16 DIN 912 Stainless Steel for 44532	24892.4
AH561	Retainer Di.45xD.62xW.10 00063BRG for 44532	00131.7	AH584	Full Double Bearing for 44532	08266.0	30059	Omcan Packaging Logo for 44532	27155.1
AH562	Bearing 6205 Z Di.25xD.52xW.15 for 44532	00132.5	AH585	PFS FCH UNC1/4"x1/2" RTIN for 44532	08814.5	AH595	PFS M5x16 DIN 965 Stainless Steel for 44532	27296.5
AH563	Bearing 6206 Z Di.30xD.62xW.16 for 44532	00133.3	38482	Screw M5x10 DIN 84 INOX for 44532	09197.9	67037	Foot BOR.Red.C/PFS M10x30 D.50x34x30 ALT for 44532	29340.7
AH564	Central Axle Z-13 for 44532	00134.1	AF878	Screw M4x10 DIN 912 INOX for 44532	09198.7	AE677	Key W / PROT.30223 M2FT2FE3V / 19 for 44532	30565.0
AH565	Central Axle Flange for 44532	00135.0	38404	Nut M4 DIN 934 for 44532	09205.3	67038	Grounded Wire Label for 44532	31140.5
AH566	PCA FIN.UNC 1.3/8" Brass for 44532	00138.4	38527	Cord 3x2.5mm2 for 44532	09551.6	27726	Cord Holder PG13.5 LC+P/9 for 44532	31923.6
AH567	Prision UNC3/8x2 ZB for 44532	00139.2	78916	Attention Caution Port for 44532	09641.5	AF904	Screw M4x8 DIN 985 INOX for 44532	32433.7
AH568	Female Handle with Thread 3/8" for 44532	00140.6	AH586	Attention Label Spanish/English/Port for 44532	10240.7	AH596	Attention Care Symbol Label ENG for 44532	32572.4
AH569	Expelling Plate for 44532	00141.4	AH587	PCA M10 DIN 934 ZB for 44532	12343.9	AH597	PFS M6x30 DIN 916 Stainless Steel (Obsolete) for 44532	32651.8
AH570	Base Fat.1.5/3mm for 44532	00149.0	AH588	PFS M6x16 DIN 933 INOX for 44532	12426.5	67040	Instruction Manual Label for 44532	32832.4
AH571	Grater Disc Base for 44532	00155.4	38280	Screw Nut M12 DIN934 INOX for 44532	12439.7	27754	Maintenance/Cleaning Label for 44532	34686.1
AH572	Disc Plate DES.F.3 for 44532	00156.2	16419	Washer L.A6 4 125 INOX for 44532	12442.7	AH598	PFS M4x25 DIN 965 Stainless Steel for 44532	35308.6
AH573	AD-450-S Pressure Rivet for 44532	00157.0	16421	Screw Nut M8 934 INOX for 44532	12445.1	AH599	Spiral Protection 1/2"x470mm for 44532	36845.8
AH574	Shrapping Disc Base for 44532	00159.7	38281	Screw Nut M6 DIN934 INOX for 44532	12448.6	AF923	Screw M3x8 DIN 965 INOX for 44532	37881.0
AH575	Disc Plate DES.F.5 for 44532	00163.5	16422	Screw M8x20 DIN 933 Stainless Steel for 44532	12455.9	AH600	PCA M4 DIN 985 ZB for 44532	39365.7
AH576	Disc Plate DES.F.8 for 44532	00166.0	16423	Washer L.A8.4 Stainless Steel for 44532	12460.5	67042	Emergency Button 2NF (Pull to Unlock) for 44532	40640.6
AH577	Fixing Wrench (C.Martel.) for 44532	00171.6	AH589	Electric Cable Protection for 44532	13723.5	67043	Emergency Label (10045238) for 44532	40643.0
27688	Clamp K22 (T 50R) for 44532	00210.0	38208	Wire Passer Molde 0922231 for 44532	13737.5	AH601	Washer 3mm M8 Stainless Steel for 44532	40763.1
38121	PFS Sex UNC3 8x1 RTZB for 44532	00241.0	30046	Sticker Clip for 44532	13757.0	AH602	CS Push Socket for 44532	42419.6
38381	Cover for 44532	01340.4	30047	Nut M4 DIN 934 for 44532	14175.5	AH603	Push Handle for 44532	42511.7
AH578	Driven Pulley (Primer) for 44532	01622.5	AH590	Engine 1.5CV 60Hz W BEN01542 for 44532	14858.0	AH604	Sensor Protection Plate for 44532	42517.6
AH579	Grater Disc Plate for 44532	01806.6	30048	Cable 3x0.75mm for 44532	16798.3	AH605	CS Nozzle for 44532	42584.2
AH580	Larger Hexagonal Lock for 44532	01818.0	79037	Positive Terminal Lock for 44532	17581.1	AH606	Chamber of Discs for 44532	42691.1
30350	Nylon Cover CN-4472 for 44532	02031.1	30050	Terminal Cover for 44532	17582.0	AH607	Collecting Bin W/ Support for 44532	42694.6
38469	Cover for 44532	02313.2	AH591	Motor Pulley (Primer) for 44532	19501.4	AH608	Socket Stop Bushing for 44532	42695.4
27693	Washer L.A8.4 ZB for 44532	02730.8	AH592	PFS Sex UNC1/4"x3/4" RTIN for 44532	19645.2	AH609	Collector Canister Lock Pin for 44532	42696.2
27695	Allen Screw M6x8 for 44532	03188.7	AG046	Adaptor Ring 3.96mm (Grey) for 44532	20290.8	AH610	Base Cover for 44532	43103.6
AH581	3mm Blade for 44532	03497.5	27711	Screw M5x10 DIN 933 Stainless Steel for 44532	21081.1	AH611	Full Collection Box for 44532	43106.0
AH582	1.5mm Blade for 44532	03498.3	AF890	Nut M6 DIN 1587 INOX for 44532	22200.3	AH612	Base of the Camera for 44532	43345.4

# Parts Breakdown

## Model FP-BR-0014 44532

Item No.	Description	Position	Item No.	Description	Position	Item No.	Description	Position
AH613	CS Engine Cabinet for 44532	43348.9	AH632	CH.P.BUT.W/D.Channel 1m Complete Hardhu for 44532	46785.5	AH649	Actuator+Sensor Set SSH5-30R1P4A + A for 44532	53182.0
AH614	Pushing Rod for 44532	43355.1	AH633	CB.3x1.5mm2x1800mm PG180 16A 3PR H07R for 44532	46862.2	AH650	Pushing Rod for 44532	54283.0
AH615	Base Support Rod (Black) for 44532	43599.6	AH634	Single-Phase Safety Unit with Brake for 44532	46952.1	AH651	Stem Bearing for 44532	54285.7
AH616	RT NR12 Actuator for 44532	43773.5	AH635	Container Fitting Label for 44532	47012.0	AH652	Rod Stop for 44532	54729.8
AH617	Dry-Met Bushing 5/8x23/32x5/8 for 44532	44151.1	AH636	Key W/PROT.30223 M2FT2EE3Y/19 for 44532	47044.9	AH653	Actuator Support Plate for 44532	55640.8
AH618	Belt 25 for 44532	44603.3	AH637	Push Rod Bushing for 44532	47088.0	AH654	CS Engine Cabinet for 44532	55839.7
AH619	Label Do Not Use JATO AGUA GR. for 44532	44938.5	AH638	Supply Stop Stem Push. for 44532	47089.9	AH655	Plate Closing Plate for 44532	55841.9
AH620	Equipotential Symbol Label for 44532	45006.5	AH639	Push Rod Stop for 44532	47091.0	AH656	O Ring 36.8x29.74x3.53mm for 44532	55842.7
AH621	Sensor Support for 44532	45082.0	AH640	ARR.PB4 DIN 127 Stainless Steel for 44532	47397.9	AH657	Central Axle Z-13 for 44532	55843.5
AH622	10mm Shoe Mechanical Therm for 44532	45327.7	AH641	Motor 1CV 60Hz 127V W (12027724) for 44532	47952.7	AH658	Central Axle Flange for 44532	56090.1
AH623	Sensor RT NR12 1m for 44532	45653.5	AH642	CS Base for 44532	48217.0	AH659	Single-Phase Safety Unit with Brake for 44532	58886.5
AH624	CB.4x0.33mm2X1000mm with Brake Connector for 44532	45723.0	AH643	Attention Label GR. for 44532	48471.7	AH660	CS Base for 44532	58889.0
AH625	CB.2x0.33mm2X1000mm with Brake Connector for 44532	45727.2	65979	On/Off Key without/LED for 44532	48557.8	AH661	Sensor Support for 44532	58892.0
AH626	General Key Label for 44532	46509.7	AH644	CB.4x0.33mm2X1000mm with 6 VI Connector for 44532	49464.0	AH662	Sensor Fixer for 44532	58894.6
AH627	1NA Reset Button for 44532	46526.7	67050	Actuator 1 Channel for 44532	49717.7	AH663	Collecting Bin with IMA for 44532	58897.0
AH628	Support Shaft for 44532	46531.3	AH645	Sensor 1 Channel 500mm EXCON for 44532	49760.6	AH664	CS Cabinet for 44532	60895.5
AH629	CS BNS Sensor Support for 44532	46539.9	AH646	1m EXCON Extension Whip for 44532	50501.3	AH665	1000mm EXCON 1 Channel Sensor for 44532	61141.7
AH630	CB.4x0.33mm2X1000mm with 6 VI Connector for 44532	46646.8	AH647	Ring for Key FE006-158 for 44532	51307.5	AH666	Container Fitting Label for 44532	61225.1
AH631	Emergency Button Label (Obsolete) for 44532	46670.0	AH648	Emergency Button Label for 44532	51369.5	AH667	CS Base for 44532	65732.8