

Parts Breakdown

Model JE-BR-1750-Q 46957

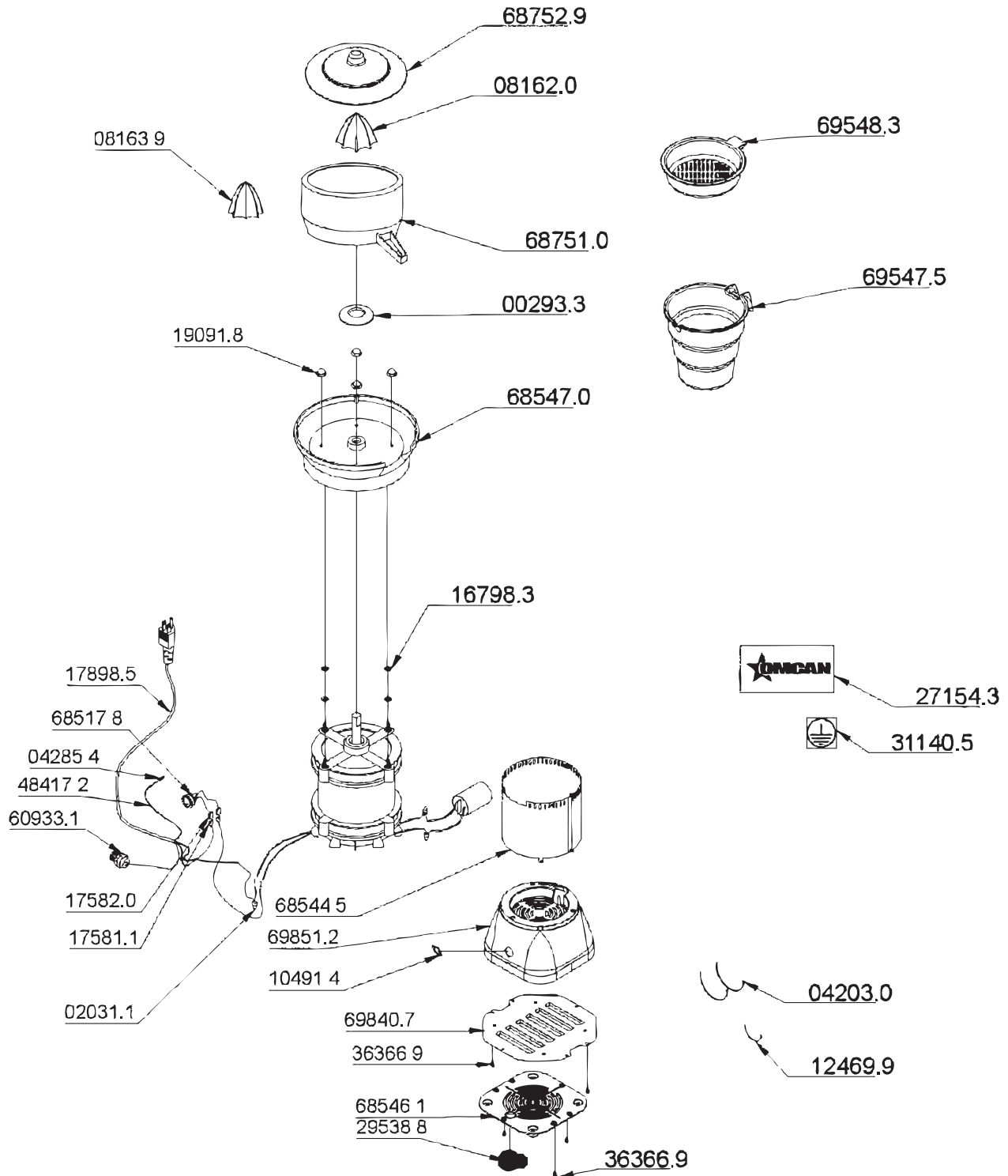

Parts Breakdown

Model JE-BR-1750-Q 46957

Item No.	Description	Position	Item No.	Description	Position	Item No.	Description	Position
30031	Rubber Seal MOL 085375 for 46957	00293.3	30050	Terminal Cover for 46957	17582.0	AE758	Motor 0,25CV 110-127/220-254/220V 50 for 46957	65970.3
30350	Nylon Cover CN-4472 for 46957	02031.1	30305	Cable 3x1.0mm with Plug for 46957	17898.5	AE759	Key 16123 M5FT4FE3Gy / 220 with 1 RAB for 46957	68517.8
27699	Clamp T 18R Small for 46957	04203.0	38148	Nut M4 DIN 1587 for 46957	19091.8	AE760	Closure for 46957	68546.1
38089	Pre Isolating Terminal for 46957	04285.4	27720	Omcan Logo (Machines) for 46957	27154.3	AE761	Black Engine Support Flange for 46957	68547.0
16407	Large Crown (for Orange) for 46957	08162.0	78995	Rubber Buffer for 46957	29538.8	AE762	Camera with Open Nozzle for 46957	68751.0
16408	Small Crown (for Lemon) for 46957	08163.9	67038	Grounded Wire Label for 46957	31140.5	AE763	Cover (Black) for 46957	68752.9
30044	On/Off Label for 46957	10491.4	67039	Nut M4 DIN 985 Stainless Steel for 46957	31800.0	AE764	Cup (Black) for 46957	69547.5
30045	Bracer K22-LM(T-80I) for 46957	12469.9	30066	Screw B.3,5x10 ZB PLAST.C/P for 46957	36366.9	AE765	Mold Screen 084735 (Black) for 46957	69548.3
30048	Cable 3x0,75mm for 46957	16798.3	AE756	CB. Earth 1.5mm2x350mm for 46957	48417.2	AE766	Closing the Fund for 46957	69840.7
79037	Positive Terminal Lock for 46957	17581.1	AE757	Press CB.PG09 Black (CLCP09B) for 46957	60933.1	AE767	Black Base Ring for 46957	69851.2