

Parts Breakdown

Model RE-CN-0060 48563

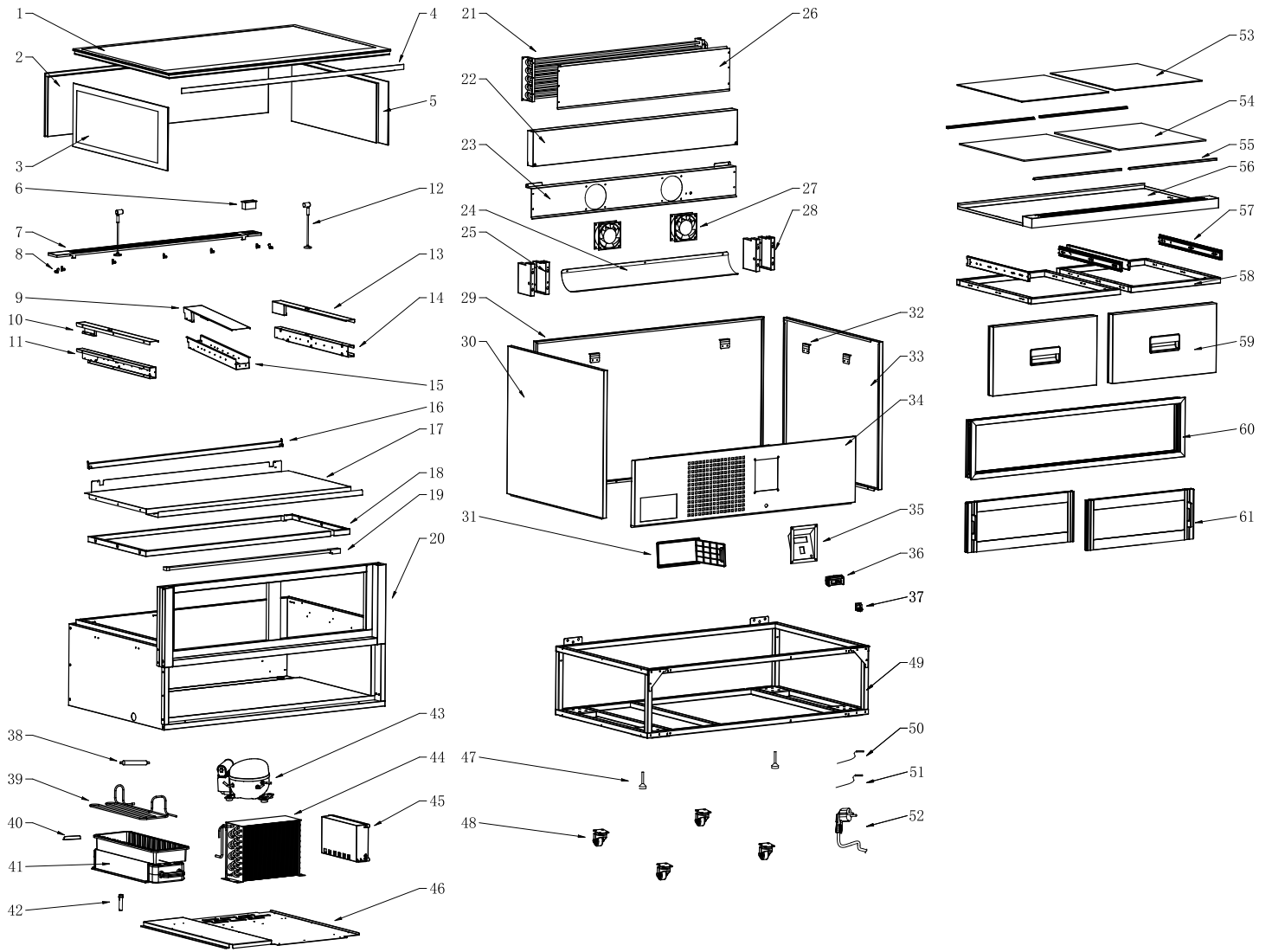

Parts Breakdown

Model RE-CN-0060 48563

Item No.	Description	Position	Item No.	Description	Position	Item No.	Description	Position
AT869	Top Glass for 48563	1	AT854	Air Deflector for 48563	24	AT805	Water Level Monitoring Sleeve for 48563	42
AT870	Front Glass for 48563	2	AT782	Evaporator Right Windshield for 48563	25	AT806	Compressor for 48563	43
AT762	Right Glass for 48563	3	AT855	Evaporator Fixing Plate for 48563	26	AL812	Condenser for 48563	44
AT871	Top Glass Trim for 48563	4	AR383	Fan Motor for 48563	27	AR527	Motor for 48563	44
AT764	Left Glass for 48563	5	AT784	Evaporator Left Windshield for 48563	28	AL828	Condenser Fan for 48563	44
AT872	Front Display for 48563	6	AT881	Front Frame for 48563	29	AL827	Flange for 48563	44
AT873	Air Outlet for 48563	7	AT786	Right Frame for 48563	30	AT807	Junction Box Bottom for 48563	45
AT766	Inlet and Outlet Limit for 48563	8	AT787	Water Box Door for 48563	31	AT808	Junction Box Cover for 48563	45
AT845	Pull Door Track Trim Piece for 48563	9	AT788	Water Box Door Body for 48563	31	AT809	Digital Control for 48563	45
AT767	Pull Door Track Right Trim Piece for 48563	10	AT789	Frame Support for 48563	32	AT810	Switch for 48563	45
AT768	Pull Door Track Right Fixed Plate for 48563	11	AT790	Left Frame for 48563	33	AT811	Base Plate for 48563	46
AT769	LED Spotlights for 48563	12	AT882	Rear Lower Frame for 48563	34	AR334	Adjustable Foot for 48563	47
AT770	Pull Door Track Left Trim Piece for 48563	13	AT792	Switch Panel for 48563	35	AL824	Caster for 48563	48
AT771	Pull Door Track Left Fixed Plate for 48563	14	AR356	Display for 48563	36	AT883	Base Parts for 48563	49
AT846	Pull Door Track Fixed Plate for 48563	15	AL834	Switch for 48563	37	AT813	Box Base Left Connector for 48563	49
AT874	Pull Door Track Support for 48563	16	AT793	Dry Filter for 48563	38	AT814	Box Base Right Connector for 48563	49
AT875	Top Trim Cover for 48563	17	AT794	High Pressure Vaporized Copper Pipe for 48563	39	AT815	Box Base Connector for 48563	49
AT876	Top Trim for 48563	18	AT795	Water Storage Box Baffle for 48563	40	AR273	Temp Probe for 48563	50
AT877	LED for 48563	19	AT796	Water Box for 48563	41	AR274	Overheating Probe for 48563	51
AT878	Box Foam Assembly for 48563	20	AT797	Cover Plate for 48563	41	AT816	American Semi-Finished Power Cord for 48563	52
AL817	Water Leakage Pipe for 48563	20	AT798	Water Storage Box for 48563	41	AT884	Light Guide Plate Glass for 48563	53
AT776	Drain Pipe Connection for 48563	20	AT799	Magnetic Door Contact for 48563	41	AT885	Light Guide Plate for 48563	54
AT777	Drain Pipe Clamp for 48563	20	AT800	Water Box Left Fixing Plate for 48563	41	AT886	Light Guide Plate Light Bar Fastener for 48563	55
AR345	Nut for 48563	20	AT801	Water Box Cover Fixing Plate for 48563	41	AT887	LED for 48563	55
AT851	Evaporator for 48563	21	AT802	Water Box Cover Plate for 48563	41	AT888	Light Guide Plate Placement Plate for 48563	56
AT879	Evaporator Front Trim Plate for 48563	22	AT803	Water Level Monitoring Pipe for 48563	42	AT822	Sliding Rail for 48563	57
AT880	Motor Fixing Plate for 48563	23	AT804	Water Level Monitoring Diversion Device for 48563	42	AT889	Door Slide Rail Assembly for 48563	58

Parts Breakdown

Model RE-CN-0060 48563

Item No.	Description	Position	Item No.	Description	Position	Item No.	Description	Position
AT890	Door Foam Assembly for 48563	59	AT830	Door Frame Block for 48563	60	AT836	Side Handle for 48563	61
AT891	Door Gasket for 48563	59	AT831	Door Suction Bar for 48563	60	AT837	Pulley for 48563	61
AT826	Sliding Door Left Trim for 48563	59	AT832	Door Frame Connector for 48563	60	AT838	Handle for 48563	61
AT827	Sliding Door Right Trim for 48563	59	AT833	Door Frame Fixed Part for 48563	60	AT839	Gate Magnetic Strip for 48563	61
AT892	Upper and Lower Door Beam for 48563	60	AT893	Upper and Lower Door Frame for 48563	61	AT894	Door Glass for 48563	61
AT829	Left and Right Door Beam for 48563	60	AT835	Side Door Frame for 48563	61			