



SERVING THE FOOD INDUSTRY SINCE 1951

47" Double Sliding Glass Door Refrigerator, Black 29.5 cu.ft. (835 L), 115 V/60 Hz/1 Ph

ITEM: 48664
MODEL: RE-CN-0810



Perfect refrigerator for merchandise display & customer convenience.

Designed for durability and efficiency, this spacious double glass door stainless steel refrigerator combines a modern appearance with high-performance components. Perfect for front-of-house applications and customer-facing environments.

FEATURES:

- Exterior material: Black-coated steel
- Plastic-coated Steel Shelves
- Automatic Defrosting
- Polyurethane Foam Insulation
- Eco-friendly R290 Refrigerant
- Digital Temperature Control

Telephone: 1-800-465-0234

Fax: (905) 607-0234

Email: sales@omcan.com

Website: www.omcan.com



Authorized Dealer



Made in China

(Updated 2026.06 tp)

Page 1 / 2

TECHNICAL DRAWING

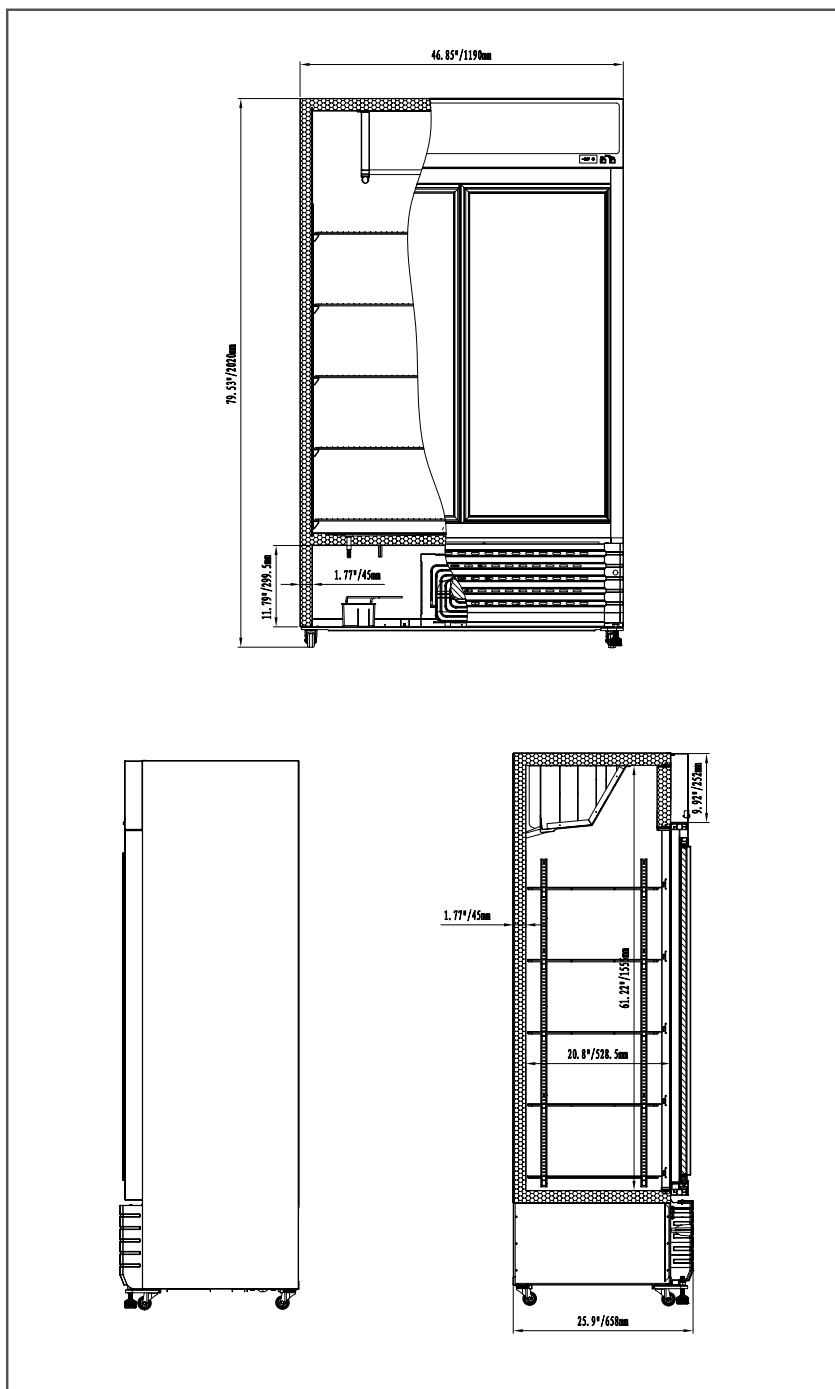

TECHNICAL SPECIFICATION

Item	48664
Model	RE-CN-0810
Capacity	29.5 cu. ft. / 835 L
Max Shelf Capacity	99.2 lb (45 kg)
Number of Doors	2 Sliding Glass Doors
Number of Shelves	8
Shelf Size	19.4" x 21" (492 x 531 mm)
Shelf Material	Plastic Coated Steel
Exterior Material	Painted Steel (Black-coated)
Number of Casters	4
Power	500 W
Amps	4.0 A
Electrical	115 V / 60 Hz / 1 Ph
Temperature Controller	Digital
Temperature Range	1 - 10°C (34 - 50°F)
Refrigerant	R290
Max Ambient Temp	40°C (104°F)
Insulation Material	Cyclopentane
Defrosting	Automatic
Cooling System	Ventilated
Interior Dimensions (WDH)	43.31" x 20.87" x 52.17" (1100 x 530 x 1325 mm)
Net Dimensions (WDH)	47" x 26" x 80" (1190 x 660 x 2020 mm)
Net Weight	313 lb (142 kg)

Dimensions rounded up to the nearest tenth inch or millimeter.
Specifications subject to change without notice.