

PARTS BREAKDOWN

| ITEM | MODEL |
|-------|------------|
| 13163 | MX-IT-0020 |

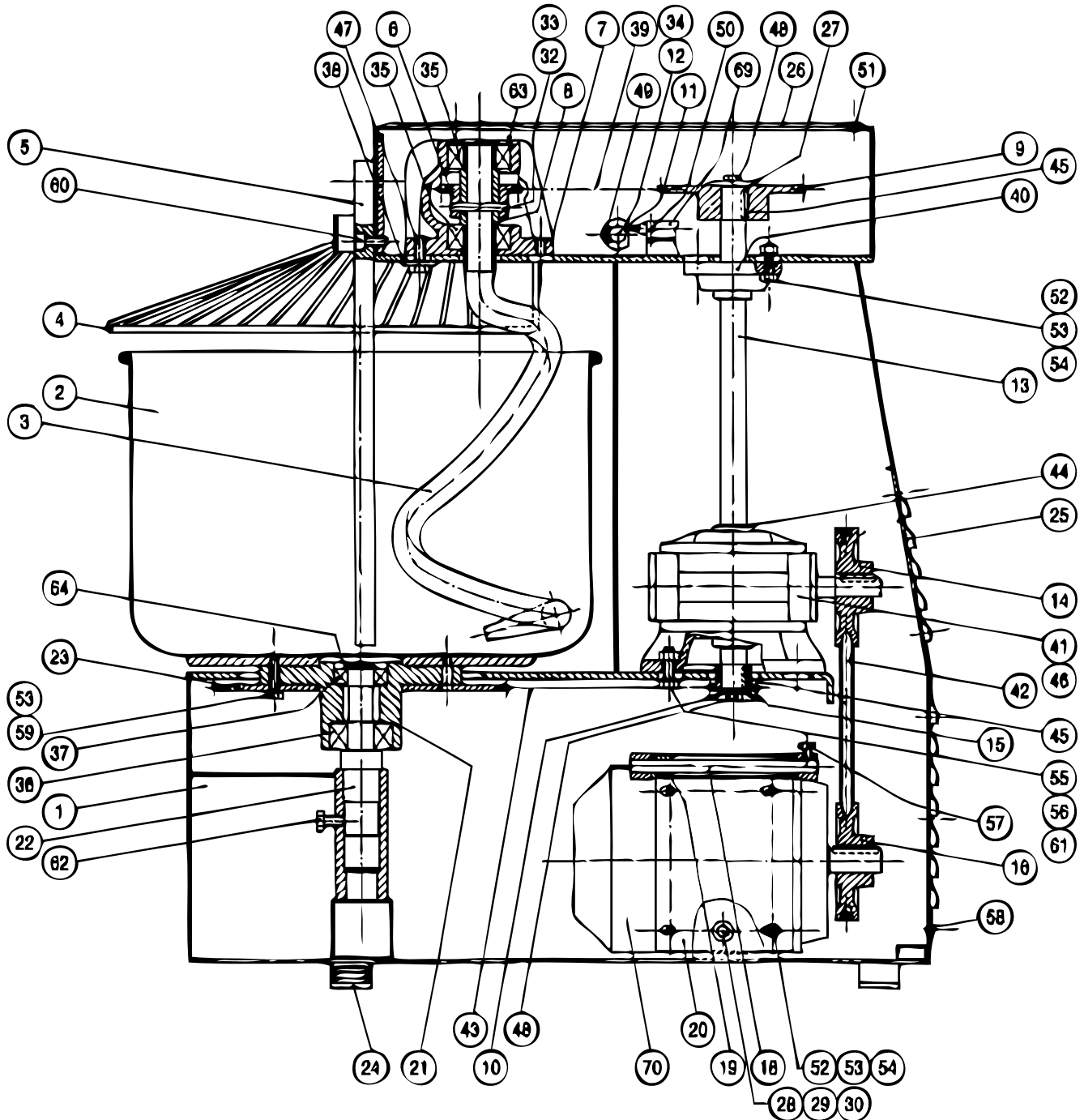

PARTS BREAKDOWN

| ITEM | MODEL |
|-------|------------|
| 13163 | MX-IT-0020 |

| Item No. | Description | Position | Item No. | Description | Position | Item No. | Description | Position |
|----------|------------------------------|----------|----------|----------------------------|----------|----------|------------------------|----------|
| 75570 | Base for 13163 | 1 | 75592 | Crown Z = 85 3/8 for 13163 | 23 | 75614 | Tongue for 13163 | 46 |
| 75571 | Basin for 13163 | 2 | 75593 | Shock Absorber for 13163 | 24 | 75615 | Screw TE for 13163 | 47 |
| 75572 | Auger for 13163 | 3 | 75594 | Rear Protection for 13163 | 25 | 75616 | Screw TE for 13163 | 48 |
| 75573 | Shelter for 13163 | 4 | 75595 | Shelter Tested for 13163 | 26 | 75617 | Screw STEI for 13163 | 49 |
| 75574 | Central Rod for 13163 | 5 | 75596 | Washer for 13163 | 27 | 75618 | Screw TC for 13163 | 50 |
| 75575 | Pinion Z = 15 1/2 for 13163 | 6 | 75597 | Washer for 13163 | 28 | 75619 | Screw TS for 13163 | 51 |
| 75576 | Support X Auger for 13163 | 7 | 75598 | Rod for 13163 | 29 | 75620 | Screw TE for 13163 | 52 |
| 75577 | Compass X Auger for 13163 | 8 | 75599 | Screw for 13163 | 30 | 75621 | Washer for 13163 | 53 |
| 75578 | Pinion Z = 29 1/2 for 13163 | 9 | 75600 | Spring Pin for 13163 | 32 | 75622 | Nut for 13163 | 54 |
| 75579 | Washer for 13163 | 10 | 75601 | Spring Pin for 13163 | 33 | 75623 | Screw TE for 13163 | 55 |
| 75580 | Cam X Microswitch for 13163 | 11 | 75602 | Spring Pin for 13163 | 34 | 75624 | Washer for 13163 | 56 |
| 75581 | Tree X Shelter for 13163 | 12 | 75603 | Bearing for 13163 | 35 | 75625 | Screw TE for 13163 | 57 |
| 75582 | Tree X Reducer for 13163 | 13 | 75604 | Bearing for 13163 | 36 | 75626 | Screw TC for 13163 | 58 |
| 75583 | Pulley Reducer for 13163 | 14 | 75605 | Bearing for 13163 | 37 | 75627 | Screw TE for 13163 | 59 |
| 75584 | Pinion Z = 15 3/8 for 13163 | 15 | 75606 | Washer for 13163 | 38 | 75628 | Screw TCEI for 13163 | 60 |
| 75585 | Motor Pulley for 13163 | 16 | 75607 | Single Chain for 13163 | 39 | 75629 | Nut for 13163 | 61 |
| 75586 | Spring for 13163 | 17 | 75608 | Support SKF for 13163 | 40 | 75630 | Screw TE for 13163 | 62 |
| 75587 | Tree X Motor Mount for 13163 | 18 | 75609 | Reducer R = 1/19 for 13163 | 41 | 75631 | Elastic Ring for 13163 | 63 |
| 75588 | Bush for 13163 | 19 | 75610 | V-Belt for 13163 | 42 | 75632 | Elastic Ring for 13163 | 64 |
| 75589 | Engine Support for 13163 | 20 | 75611 | Single Chain for 13163 | 43 | 75633 | Microswitch for 13163 | 69 |
| 75590 | Support X Basing for 13163 | 21 | 75612 | Elastic Ring for 13163 | 44 | 75634 | Motor for 13163 | 70 |
| 75591 | Tree Basin for 13163 | 22 | 75613 | Tongue for 13163 | 45 | | | |