



## ***Display Warmers***

Models DW-CN-0076, 0096, 0136, 0186

Items 44437, 40003, 39999, 44438

## ***Instruction Manual***



*Revised - 12/10/2024*

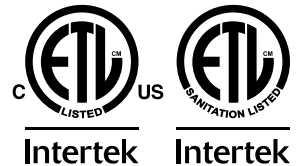

Toll Free: 1-800-465-0234  
Fax: 905-607-0234  
Email: [service@omcan.com](mailto:service@omcan.com)  
[www.omcan.com](http://www.omcan.com)



# ***Table of Contents***

Model DW-CN-0076 / Model DW-CN-0096  
Model DW-CN-0136 / Model DW-CN-0186

---

<b>Section</b>	<b>Page</b>
General Information -----	3 - 4
Safety and Warranty -----	4 - 6
Technical Specifications -----	6 - 7
Installation -----	7
Operation -----	7 - 8
Maintenance -----	8 - 9
Parts Breakdown -----	10 - 17
Electrical Schematics -----	18
Warranty Registration -----	19



## **General Information**

---

**Omcan Manufacturing and Distributing Company Inc., Food Machinery of America, Inc. dba Omcan and Omcan Inc. are not responsible for any harm or injury caused due to any person's improper or negligent use of this equipment. The product shall only be operated by someone over the age of 18, of sound mind, and not under the influence of any drugs or alcohol, who has been trained in the correct operation of this machine, and is wearing authorized, proper safety clothing. Any modification to the machine voids any warranty, and may cause harm to individuals using the machine or in the vicinity of the machine while in operation.**

### **CHECK PACKAGE UPON ARRIVAL**

Upon receipt of an Omcan shipment please inspect for external damage. If no damage is evident on the external packaging, open carton to ensure all ordered items are within the box, and there is no concealed damage to the machine. If the package has suffered rough handling, bumps or damage (visible or concealed), please note it on the bill of lading before accepting the delivery and contact Omcan within 24 hours, so we may initiate a claim with the carrier. A detailed report on the extent of the damage caused to the machine must be filled out within three days, from the delivery date shown in the shipping documents. Omcan has no recourse for damaged products that were shipped collect or third party.

**Before operating any equipment, always read and familiarize yourself with all operation and safety instructions.**

**Omcan would like to thank you for purchasing this machine. It's of the utmost importance to save these instructions for future reference. Also save the original box and packaging for shipping the equipment if servicing or returning of the machine is required.**

---

**Omcan Fabrication et distribution Compagnie Limité et Food Machinery d'Amérique, dba Omcan et Omcan Inc. ne sont pas responsables de tout dommage ou blessure causé du fait que toute personne ait utilisé cet équipement de façon irrégulière. Le produit ne doit être exploité que par quelqu'un de plus de 18 ans, sain d'esprit, et pas sous l'influence d'une drogue ou d'alcool, qui a été formé pour utiliser cette machine correctement, et est vêtu de vêtements de sécurité appropriés. Toute modification de la machine annule toute garantie, et peut causer un préjudice à des personnes utilisant la machine ou des personnes à proximité de la machine pendant son fonctionnement.**

### **VÉRIFIEZ LE COLIS DÈS RÉCEPTION**

Dès réception d'une expédition d'Omcan veuillez inspecter pour dommages externes. Si aucun dommage n'est visible sur l'emballage externe, ouvrez le carton afin de s'assurer que tous les éléments commandés sont dans la boîte, et il n'y a aucun dommage dissimulé à la machine. Si le colis n'a subi aucune mauvaises manipulations, de bosses ou de dommages (visible ou cachée), notez-le sur le bond de livraison avant d'accepter la livraison et contactez Omcan dans les 24 heures qui suivent, pour que nous puissions engager une réclamation auprès du transporteur. Un rapport détaillé sur l'étendue des dommages causés à la machine doit être rempli dans un délai de trois jours, à compter de la date de livraison indiquée dans les documents d'expédition. Omcan n'a aucun droit de recours pour les produits endommagés qui ont été expédiés ou cueillis par un tiers transporteur.

**Avant d'utiliser n'importe quel équipement, toujours lire et vous familiariser avec toutes les opérations et les**

## ***General Information***

---

consignes de sécurité.

Omcan voudrais vous remercier d'avoir choisi cette machine. Il est primordial de conserver ces instructions pour une référence ultérieure. Également conservez la boîte originale et l'emballage pour l'expédition de l'équipement si l'entretien ou le retour de la machine est nécessaire.

Omcan Empresa De Fabricacion Y Distribucion Inc. Y Maquinaria De Alimentos De America, Inc. dba Omcan y Omcan Inc. no son responsables de ningun daño o perjuicio causado por cualquier persona inadecuada o el uso descuidado de este equipo. El producto solo podra ser operado por una persona mayor de 18 años, en su sano juicio y no bajo alguna influencia de droga o alcohol, y que este ha sido entrenado en el correcto funcionamiento de esta máquina, y ésta usando ropa apropiada y autorizada. Cualquier modificación a la máquina anula la garantía y puede causar daños a las personas usando la máquina mientras esta en el funcionamiento.

### **REVISE EL PAQUETE A SU LLEGADA**

Tras la recepcion de un envio Omcan favor inspeccionar daños externos. Si no hay daños evidentes en el empaque exterior, Habra el carton para asegurarse que todos los articulos solicitados estén dentro de la caja y no encuentre daños ocultos en la máquina. Si el paquete ha sufrido un manejo de poco cuidado, golpes o daños (visible o oculto) por favor anote en la factura antes de aceptar la entrega y contacte Omcan dentro de las 24 horas, de modo que podamos iniciar una reclamación con la compañía. Un informe detallado sobre los daños causados a la máquina debe ser llenado en el plazo de tres días, desde la fecha de entrega que se muestra en los documentos de envío. Omcan no tiene ningun recurso por productos dañados que se enviaron a recoger por terceros.

**Antes de utilizar cualquier equipo, siempre lea y familiarizarse con todas las instrucciones de funcionamiento y seguridad.**

Omcan le gustaría darle las gracias por la compra de esta máquina. Es de la mayor importancia para salvar estas instrucciones para futuras consultas. Además, guarda la caja original y el embalaje para el envío del equipo si servicio técnico o devolución de la máquina que se requiere.

## ***Safety and Warranty***

---

1. This instruction manual contains information about the installation, operation and maintenance of the device and should be consulted as an important source of information and reference guide.
  2. Awareness of the safety instructions and instructions for use in this manual will ensure the safe and correct use of the device.
- To prevent hazards and to ensure optimum efficiency, no modifications or alterations to the device that are not explicitly approved by Omcan may be undertaken. This device may only be operated when in proper working condition.



# Safety and Warranty

- The device should be never left unattended during operation. Keep children away.
- Preserve this manual safely. When passing on/selling the device to a third party, the manuals must be handed over along with the device.
- Every person using the device must act in accordance to the manuals and under consideration of the safety advice.
- The device is to be used indoors only.
- Any technical interventions, as well as assembly and maintenance are to be made by a qualified customer service only.
- This appliance is not intended for use by persons (including children) with reduced physical, sensory or mental capabilities, or lack of experience and knowledge, unless they have been given supervision or instruction concerning use of the appliance by a person responsible for their safety.
- Children should be supervised to ensure that they do not play with the appliance.
- The operation manual is not suitable for the persons (including children) with reduced physical, sensory or mental capabilities, or lack of experience and knowledge.

<p><b>Exclusive power outlet</b> The power outlet must be in close proximity to the ground.</p>	<p><b>No shared power outlets</b> Warmer cable should never share the power outlet with any other appliance, as cable may overheat and may result in a fire.</p>
<p><b>Protect cables</b> Extra caution should be used when handling cables, as broken or damaged cables can cause sparking and may result in a fire.</p>	<p><b>No water flushing</b> Never flush the warmer surface. This can cause leakage, which may result in electrical damage or fire.</p>
<p><b>Never store flammables and explosives</b> No explosives or flammables should be stored in, or in proximity to, the warmer, such as gasoline, alcohol, and adhesives.</p>	

Omcan display warmers are engineered and designed to maintain previously cooked foods at serving temperatures. Improper use of this machine’s maximum temperature for extended periods of time, in an attempt to thoroughly cook food products, is prohibited. Such operation will void the manufacturer’s warranty and may result in under-cooked and unsafe food.

**RESIDENTIAL USERS: vendor assumes no liability for parts or labor coverage for component failure or other damages resulting from installation in non-commercial or residential applications. The right is reserved to deny shipment for residential usage; if this occurs, you will be notified as soon as possible.**

## 1 YEAR PARTS AND LABOUR WARRANTY

Within the warranty period, contact Omcan Inc. at 1-800-465-0234 to schedule an Omcan authorized service technician to repair the equipment locally.

Unauthorized maintenance will void the warranty. Warranty covers electrical and part failures, not improper use.

## ***Safety and Warranty***

---

Please see <https://omcan.com/disclaimer> for complete info.

### **WARNING:**

The packaging components are classified as normal solid urban waste and can therefore be disposed of without difficulty.

In any case, for suitable recycling, we suggest disposing of the products separately (differentiated waste) according to the current norms.

**DO NOT DISCARD ANY PACKAGING MATERIALS IN THE ENVIRONMENT!**

## ***Technical Specifications***

---



## Technical Specifications

Model	DW-CN-0076	DW-CN-0096	DW-CN-0136	DW-CN-0186
Item Number	44437	40003	39999	44438
Temperature Range	30 - 90°C / 86 - 194°F			
Storage Volume	76 L / 2.68 cu.ft.	96 L / 3.39 cu.ft.	136 L / 4.8 cu.ft.	186 L / 6.56 cu.ft.
Power	800 W	1000 W	1100 W	1500 W
Lamp Power	1.44 W x 3			
Top Shelf Dimensions	11.4" x 11.3" 289 x 287mm	24.4" x 11.3" 621 x 287mm	33.7" x 11.3" 857 x 287mm	45.7" x 11.3" 1161 x 287mm
Middle Shelf Dimensions	11.4" x 12.4" 289 x 316mm	24.4" x 12.4" 621 x 316mm	33.7" x 12.4" 857 x 316mm	45.7" x 12.4" 1161 x 316mm
Bottom Shelf Dimensions	11.4" x 13.7" 289 x 348mm	24.4" x 13.7" 621 x 347mm	33.7" x 13.7" 857 x 347mm	45.7" x 13.7" 1161 x 347mm
Shelf Load Capacity	22 lbs. / 10 kgs.		33.1 lbs. / 15 kgs.	22 lbs. / 10 kgs.
Electrical	110-120V / 60Hz / 1			
Net Dimensions (DWH)	19.1" x 13.6" x 26.1" 484 x 345 x 663mm	19.1" x 26.6" x 26.1" 484 x 675 x 663mm	19.7" x 36" x 26.1" 484 x 915 x 663mm	19.1" x 47.8" x 26.1" 484 x 1215 x 663mm
Packaging Dimensions	21.7" x 16.1" x 28" 551 x 408 x 710mm	21.7" x 28.9" x 28" 551 x 734 x 710mm	21.7" x 38.3" x 28" 551 x 974 x 710mm	21.7" x 50.2" x 28" 551 x 1274 x 710mm
Net Weight	46.7 lbs. / 21.2 kgs.	73.9 lbs. / 33.5 kgs.	91.5 lbs. / 41.5 kgs.	117.9 lbs. / 53.5 kgs.

## Installation

- Place the device on top of a stable and even surface which supports the weight of the device, and is not heat sensitive.
- Never place the device on a flammable surface (such as table cloth, carpet, etc).
- Do not place the device near open fireplaces, electric ovens/arc furnaces/electric heaters or other heat sources.
- Ensure that the power outlet is easily accessible and within 6 feet/182.9 cm from the warmer.

## Operation

- Before the first use, clean the inner sides and the shelves with a soft cloth and a mild cleaning agent. Afterwards, dry the device thoroughly.

## ***Operation***

---

- To fill water bowl, remove the water bowl from the device and then fill the water bowl with water.
- Connect the device to a single grounded power outlet.
- Set the temperature as required for respective foods. You may adjust the desired temperature between 30-90°C / 86-194°F.
- The temperature inside of the hot display can be read from the front display.
- Put the food in appropriate containers before placing them inside the hot display.
- Always use safety gloves or tongs when placing or removing foods, as some of the device's parts become very hot.
- The foods are kept warm at the temperature set.
- Open rear side door to place or remove foods.
- Turn on light switch when inner light is desired.
- Disconnect the device from the power outlet when the device is not in use.

## ***Maintenance***

---

- Before cleaning or repairing, make sure the device has been disconnected from the power socket and has cooled down.
- Do not use any acidic agents and make sure that no water enters the device.
- To protect yourself from electric shock, never immerse the device, its cables or the plug in water or any other liquids.
- Do not use any type of water pressure jet for cleaning the device.

### **CLEANING**

- The device should be cleaned regularly.
- Clean the device in the inside and outside with a soft, damp cloth and a mild cleaning agent.
- Clean the shelves and the housing with a soft, damp cloth and a mild cleaning agent.
- Clean the water bowl regularly. Calcifications at the water bowl may be removed with common agents or liquids.
- Only use a soft cloth to clean the display warmer, and make sure you never use any kind of abrasive agents or pads which could scratch the surface.
- After the cleaning procedure, you should use a soft and dry cloth to dry and polish the surface.
- Make sure the device has been cleaned properly before storing it in a dry place.

### **MAINTENANCE**

- Check the electrical cord regularly to ensure it is not damaged in any way.
- Never use the device if the electrical cord is damaged. If the electrical cord is damaged, it must be replaced by a qualified electrician.
- Only a qualified technician should carry out repairs and maintenance of the device. Do not attempt to repair the device by yourself.



## **CAUTIONS**

Children should be supervised to ensure that they do not play with the appliance.

- If the supply cord is damaged, it must be replaced by the manufacturer, its service agent or similarly qualified persons in order to avoid a hazard.

# Parts Breakdown

**Model DW-CN-0076** 44437

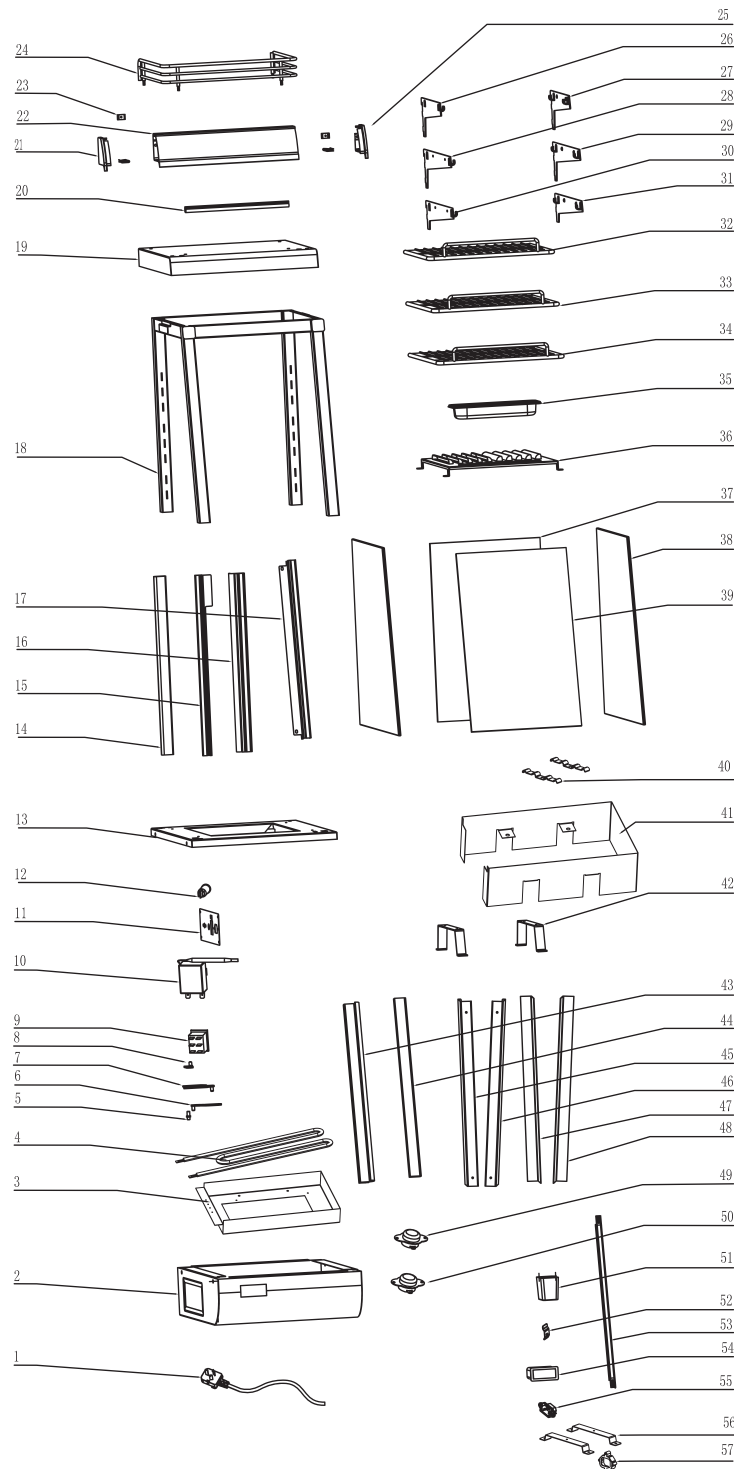

# Parts Breakdown

## Model DW-CN-0076 44437

Item No.	Description	Position	Item No.	Description	Position	Item No.	Description	Position
30621	Power Cord for 44437	1	67307	LED Lights for 44437	20	67321	Front Door Glass for 44437	39
67292	Base for 44437	2	67308	Side Cover Left for 44437	21	67322	Heating Tube Plate for 44437	40
67293	Tray for Heater for 44437	3	67309	Advertisement Light Box for 44437	22	67323	Left Panel of Heater for 44437	41
67294	Heater Element for 44437	4	67310	Nut for 44437	23	67324	Bracket for Heater for 44437	42
67295	Door Pin for 44437	5	67311	Wire Fence for 44437	24	67325	Front Door Knob Left for 44437	43
67296	Upper Hinge Back for 44437	6	67312	Side Cover Right for 44437	25	67326	Front Door Knob Right for 44437	44
67297	Upper Hinge Front for 44437	7	79322	Left Shelf Bracket for 44437	26	67327	Lamp Holder Left for 44437	45
67298	Bottom Hinge Front for 44437	8	79336	Right Shelf Bracket for 44437	27	67328	Lamp Holder Right for 44437	46
71644	On/Off Switch (Red) for 44437	9	30747	Left Shelf Bracket for 44437	28	67329	Transparent Lamp Cover Right for 44437	47
71640	Temperature Thermostat for 44437	10	30750	Right Shelf Bracket for 44437	29	67330	Transparent Lamp Cover Left for 44437	48
67299	Control Panel for 44437	11	67313	Bottom Shelf Bracket Left for 44437	30	70862	Thermostat T1/33 for 44437	49
60218	Indicator Light for 44437	12	67314	Bottom Shelf Bracket Right for 44437	31	70863	Thermostat T1M/33 for 44437	50
67300	Bottom Panel for 44437	13	67315	Bottom Shelf for 44437	32	71647	Base Feet for 44437	51
67301	Back Door Knob Left for 44437	14	67316	Middle Shelf for 44437	33	67331	Glass Clamp for 44437	52
67302	Back Door Frame for 44437	15	67317	Upper Shelf for 44437	34	67332	LED Lighting for 44437	53
67303	Back Door Knob Right for 44437	16	60735	Water Receiver for 44437	35	70686	Temperature Display for 44437	54
67304	Front Door Frame for 44437	17	67318	Ventilated Board for 44437	36	70860	Socket for 44437	55
67305	Cabinet Frame for 44437	18	67319	Back Door Glass for 44437	37	67333	Heater Brace for 44437	56
67306	Top Cover for 44437	19	67320	Side Glass for 44437	38	71638	Socket A for 44437	57

# Parts Breakdown

Model DW-CN-0096 40003

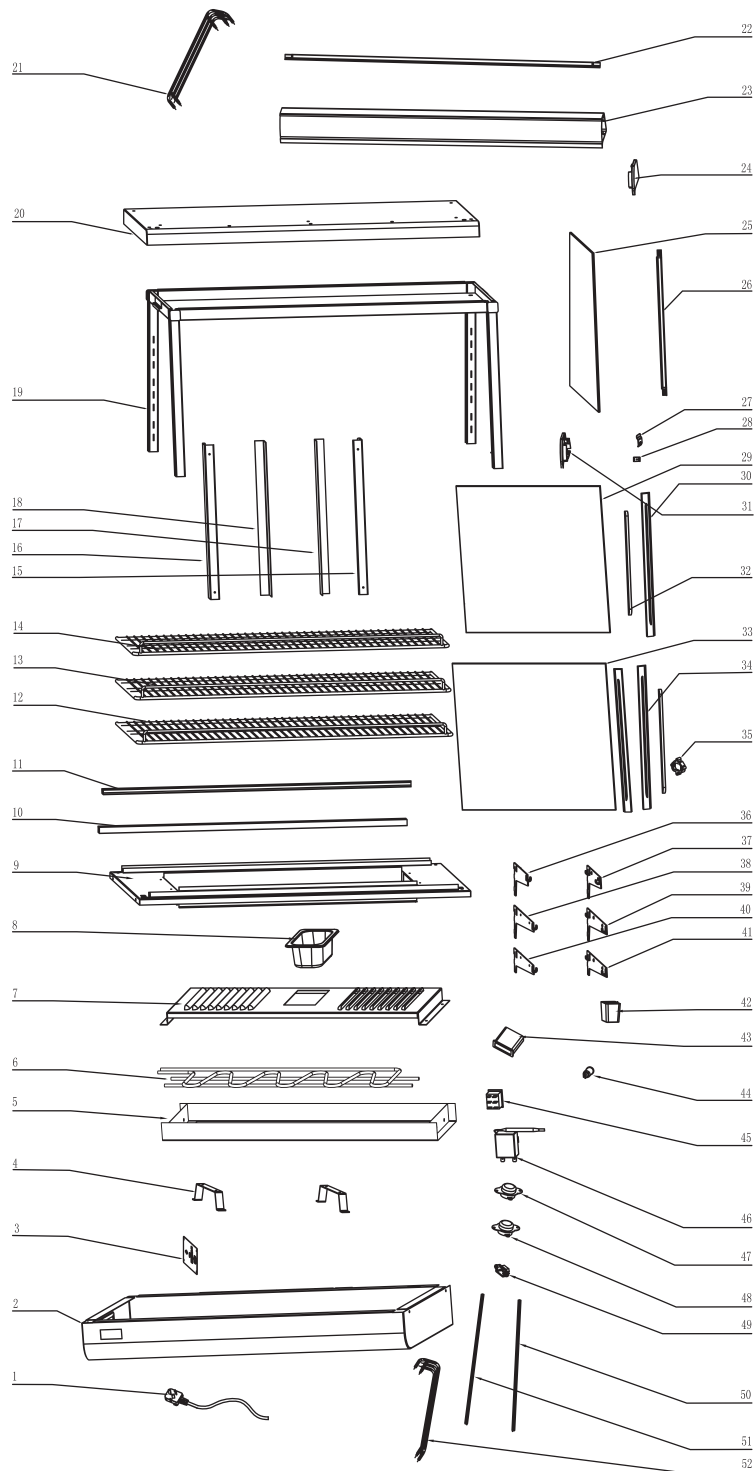

# Parts Breakdown

## Model DW-CN-0096 40003

Item No.	Description	Position	Item No.	Description	Position	Item No.	Description	Position
30621	Power Cord for 40003	1	70662	Cabinet Frame for 40003	19	71653	Right Small Bracket for 40003	37
70645	Base for 40003	2	70663	Top Cover for 40003	20	30747	Left Shelf Bracket for 40003	38
70646	Control Panel for 40003	3	70664	Wire Fence Left for 40003	21	30750	Right Shelf Bracket for 40003	39
70647	Bracket for Heater for 40003	4	70665	LED Lights for 40003	22	79322	Left Shelf Bracket for 40003	40
70648	Tray for Heater for 40003	5	70666	Advertisement Light Box for 40003	23	79336	Right Shelf Bracket for 40003	41
70824	Heating Element for 40003	6	67312	Side Cover Right for 40003	24	71647	Base Feet for 40003	42
67334	Upper Hinge Front for 40003	7	67320	Side Glass for 40003	25	70686	Temperature Display for 40003	43
71658	1/9 GN Pan for 40003	8	70669	LED Lights for 40003	26	60509	Indicating Light for 40003	44
70652	Bottom Panel for 40003	9	67331	Glass Clamp for 40003	27	70688	Switch for 40003	45
70653	Front Sliding Slot for 40003	10	67310	Nut for 40003	28	71640	Temperature Thermostat for 40003	46
70654	Back Sliding Slot for 40003	11	70672	Front Door Glass for 40003	29	70862	Thermostat T1/33 for 40003	47
70655	Bottom Shelf for 40003	12	70673	Front Door Knob for 40003	30	70863	Thermostat T1M/33 for 40003	48
70656	Middle Shelf for 40003	13	67308	Side Cover Left for 40003	31	70692	Socket Connector for 40003	49
70657	Upper Shelf for 40003	14	70675	Sheath of Door Knob for 40003	32	70693	Waterproof Strip for 40003	50
67327	Lamp Holder Left for 40003	15	70676	Back Door Glass for 40003	33	70694	Waterproof Strip for 40003	51
67328	Lamp Holder Right for 40003	16	70677	Back Door Knob for 40003	34	70695	Wire Fence Right for 40003	52
67329	Transparent Lamp Cover Right for 40003	17	70678	Socket for 40003	35			
67330	Transparent Lamp Cover Left for 40003	18	71652	Left Small Bracket for 40003	36			

# Parts Breakdown

Model DW-CN-0136 39999

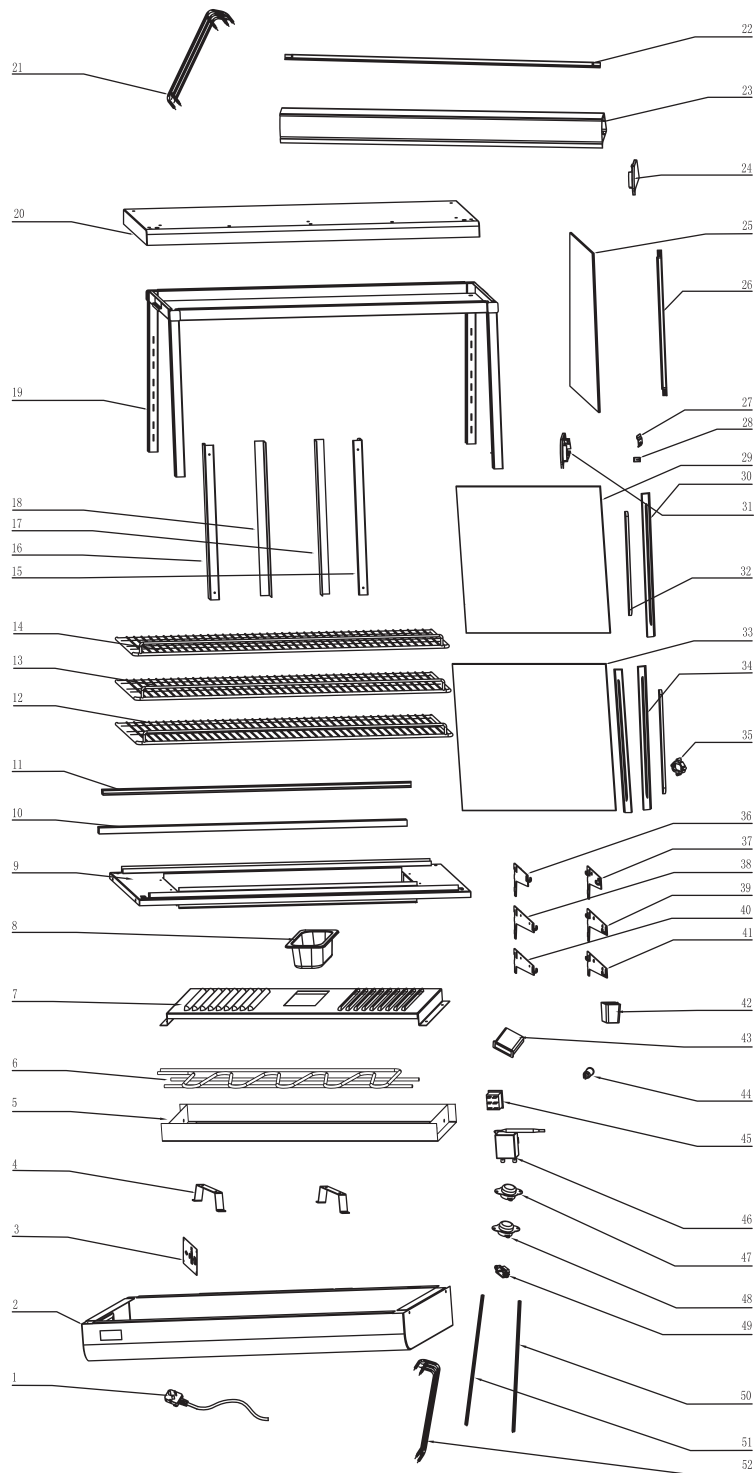



# Parts Breakdown

## Model DW-CN-0136 39999

Item No.	Description	Position	Item No.	Description	Position	Item No.	Description	Position
30621	Power Cord for 39999	1	70714	Cabinet Frame for 39999	19	71653	Right Small Bracket for 39999	37
70697	Base for 39999	2	70715	Top Cover for 39999	20	30747	Left Shelf Bracket for 39999	38
70646	Control Panel for 39999	3	70664	Wire Fence Left for 39999	21	30750	Right Shelf Bracket for 39999	39
70647	Bracket for Heater for 39999	4	70717	LED Lights for 39999	22	79322	Left Shelf Bracket for 39999	40
71688	Chassis of Heater for 39999	5	70718	Advertisement Light Box for 39999	23	79336	Right Shelf Bracket for 39999	41
70701	Heater Element for 39999	6	67312	Side Cover Right for 39999	24	71647	Base Feet for 39999	42
67297	Upper Hinge Front for 39999	7	67320	Side Glass for 39999	25	70686	Temperature Display for 39999	43
71658	1/9 GN Pan for 39999	8	70669	LED Lights for 39999	26	60509	Indicating Light for 39999	44
70704	Bottom Panel for 39999	9	67331	Glass Clamp for 39999	27	70688	Switch for 39999	45
70653	Front Sliding Slot for 39999	10	67310	Nut for 39999	28	71640	Temperature Thermostat for 39999	46
70654	Back Sliding Slot for 39999	11	70724	Front Door Glass for 39999	29	70862	Thermostat T1/33 for 39999	47
70707	Bottom Shelf for 39999	12	70673	Front Door Knob for 39999	30	70863	Thermostat T1M/33 for 39999	48
70708	Middle Shelf for 39999	13	67308	Side Cover Left for 39999	31	70692	Socket Connector for 39999	49
70709	Upper Shelf for 39999	14	70675	Sheath of Door Knob for 39999	32	70693	Waterproof Strip for 39999	50
67327	Lamp Holder Left for 39999	15	70728	Back Door Glass for 39999	33	70694	Waterproof Strip for 39999	51
67328	Lamp Holder Right for 39999	16	70677	Back Door Knob for 39999	34	70747	Wire Fence Right for 39999	52
67329	Transparent Lamp Cover Right for 39999	17	70678	Socket for 39999	35			
67330	Transparent Lamp Cover Left for 39999	18	71652	Left Small Bracket for 39999	36			

# Parts Breakdown

Model DW-CN-0186 44438

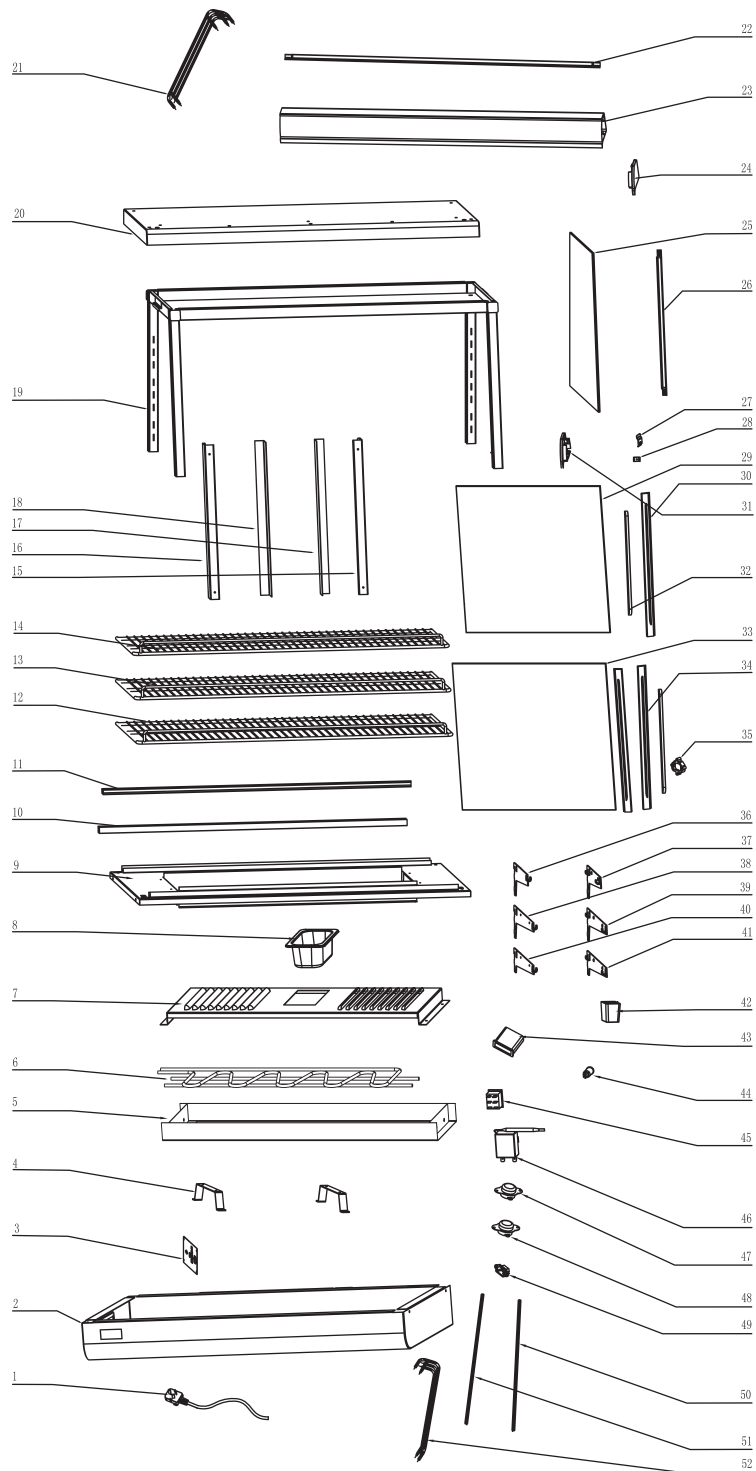



# Parts Breakdown

## Model DW-CN-0186 44438

Item No.	Description	Position	Item No.	Description	Position	Item No.	Description	Position
30621	Power Cord for 44438	1	67345	Cabinet Frame for 44438	19	79336	Right Shelf Bracket for 44438	37
67335	Base for 44438	2	67346	Top Cover for 44438	20	30747	Left Shelf Bracket for 44438	38
67299	Control Panel for 44438	3	70664	Wire Fence Left for 44438	21	30750	Right Shelf Bracket for 44438	39
70647	Bracket for Heater for 44438	4	67347	LED Lights for 44438	22	67313	Bottom Shelf Bracket Left for 44438	40
67336	Tray for Heater for 44438	5	67348	Advertisement Light Box for 44438	23	67314	Bottom Shelf Bracket Right for 44438	41
67337	Heater Element for 44438	6	67312	Side Cover Right for 44438	24	71647	Base Feet for 44438	42
67338	Ventilated Board for 44438	7	67320	Side Glass for 44438	25	70686	Temperature Display for 44438	43
71658	1/9 GN Pan for 44438	8	67332	LED Lighting for 44438	26	60218	Indicator Light for 44438	44
67339	Bottom Panel for 44438	9	67349	Glass Clamp for 44438	27	71644	On/Off Switch (Red) for 44438	45
67340	Front Sliding Slot for 44438	10	67350	Nut for 44438	28	71640	Temperature Thermostat for 44438	46
67341	Back Sliding Slot for 44438	11	67351	Side Cover Left for 44438	29	70862	Thermostat T1/33 for 44438	47
67342	Bottom Shelf for 44438	12	70673	Front Door Knob for 44438	30	70863	Thermostat T1M/33 for 44438	48
67343	Middle Shelf for 44438	13	67308	Side Cover Left for 44438	31	70860	Socket for 44438	49
67344	Upper Shelf for 44438	14	70675	Sheath of Door Knob for 44438	32	70693	Waterproof Strip for 44438	50
67327	Lamp Holder Left for 44438	15	67352	Back Door Glass with Handle for 44438	33	70694	Waterproof Strip for 44438	51
67328	Lamp Holder Right for 44438	16	67353	Back Door Knob for 44438	34	70695	Wire Fence Right for 44438	52
67329	Transparent Lamp Cover Right for 44438	17	71638	Socket A for 44438	35			
67330	Transparent Lamp Cover Left for 44438	18	79322	Left Shelf Bracket for 44438	36			

# Electrical Schematics

**Model DW-CN-0076** 44437

**Model DW-CN-0096** 40003

**Model DW-CN-0136** 39999

**Model DW-CN-0186** 44438

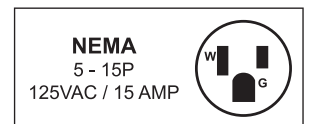
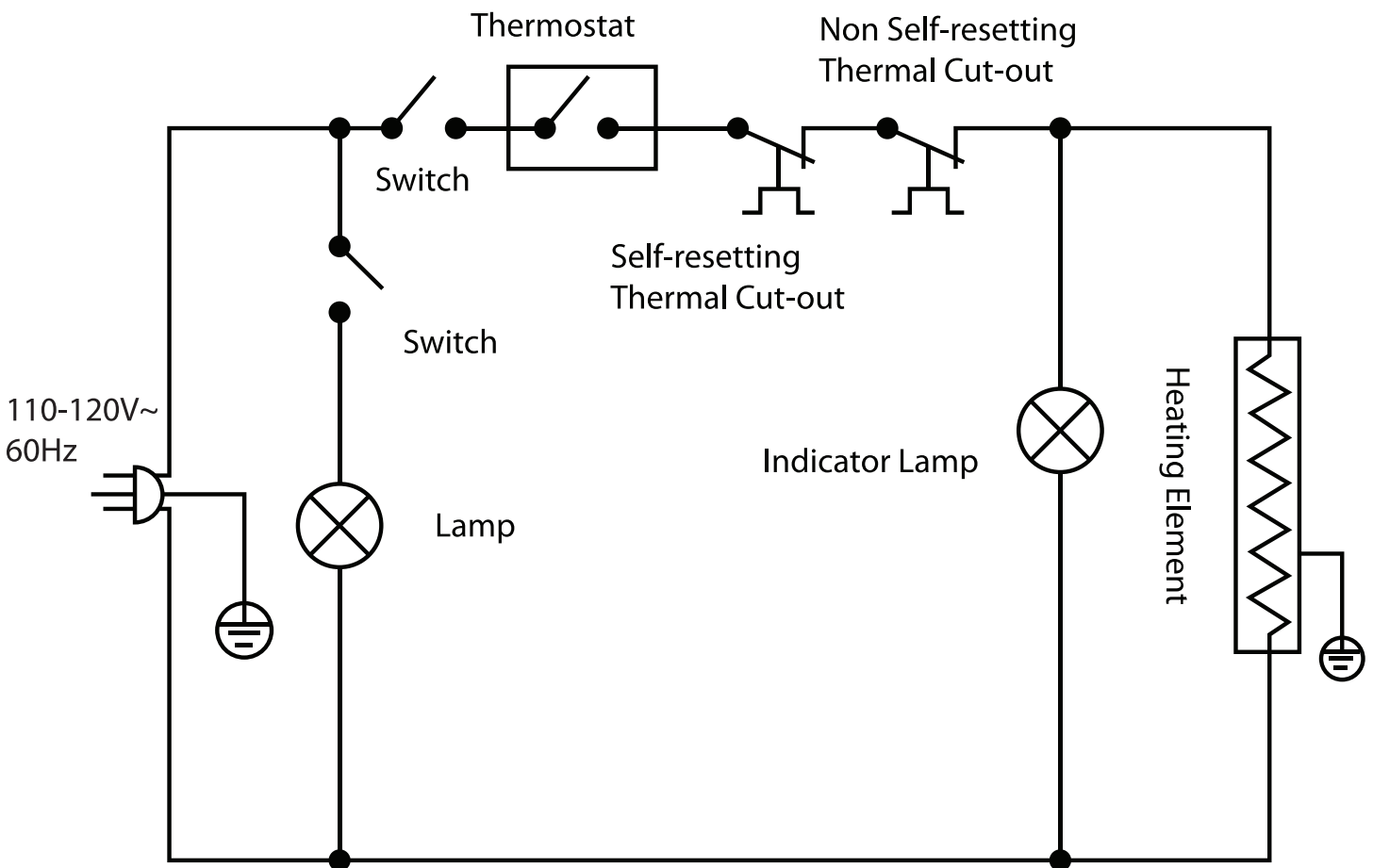



# Warranty Registration

Thank you for purchasing an Omcan product. To register your warranty for this product, complete the information below, tear off the card at the perforation and then send to the address specified below. You can also register online by visiting:

Merci d'avoir acheté un produit Omcan. Pour enregistrer votre garantie pour ce produit, complétez les informations ci-dessous, détachez la carte au niveau de la perforation, puis l'envoyer à l'adresse spécifiée ci-dessous. Vous pouvez également vous inscrire en ligne en visitant:

Gracias por comprar un producto Omcan usted. Para registrar su garantía para este producto, complete la información a continuación, cortar la tarjeta en la perforación y luego enviarlo a la dirección indicada a continuación. También puede registrarse en línea en:

<https://omcan.com/warranty-registration/>

For mailing in Canada

Pour postale au Canada

Por correo en Canadá

**OMCAN**

PRODUCT WARRANTY REGISTRATION

3115 Pepper Mill Court,  
Mississauga, Ontario  
Canada, L5L 4X5

For mailing in the US

Pour diffusion aux États-Unis

Por correo en los EE.UU.

**OMCAN**

PRODUCT WARRANTY REGISTRATION

4450 Witmer Industrial Estates, Unit 4,  
Niagara Falls, New York  
USA, 14305

*or email to: [service@omcan.com](mailto:service@omcan.com)*



Purchaser's Information

Name: \_\_\_\_\_

Address: \_\_\_\_\_

City: \_\_\_\_\_ Province or State: \_\_\_\_\_ Postal or Zip: \_\_\_\_\_

Country: \_\_\_\_\_

Dealer from which Purchased: \_\_\_\_\_

Dealer City: \_\_\_\_\_ Dealer Province or State: \_\_\_\_\_

Invoice: \_\_\_\_\_

Model Name: \_\_\_\_\_ Model Number: \_\_\_\_\_

Machine Description: \_\_\_\_\_

Date of Purchase (MM/DD/YYYY): \_\_\_\_\_

Would you like to extend the warranty?  Yes  No

Company Name: \_\_\_\_\_

Telephone: \_\_\_\_\_

Email Address: \_\_\_\_\_

Type of Company:

Restaurant  Bakery  Deli

Butcher  Supermarket  Caterer

Institution (*specify*): \_\_\_\_\_

Other (*specify*): \_\_\_\_\_

Serial Number: \_\_\_\_\_

Date of Installation (MM/DD/YYYY): \_\_\_\_\_

**Thank you for choosing Omcan | Merci d'avoir choisi Omcan | Gracias por elegir Omcan**



Since 1951 Omcan has grown to become a leading distributor of equipment and supplies to the North American food service industry. Our success over these many years can be attributed to our commitment to strengthen and develop new and existing relationships with our valued customers and manufacturers. Today with partners in North America, Europe, Asia and South America, we continually work to improve and grow the company. We strive to offer customers exceptional value through our qualified local sales and service representatives who provide convenient access to over 6,500 globally sourced products.

---

Depuis 1951 Omcan a grandi pour devenir un des "leaders" de la distribution des équipements et matériel pour l'industrie des services alimentaires en Amérique du Nord. Notre succès au cours de ces nombreuses années peut être attribué à notre engagement à renforcer et à développer de nouvelles et existantes relations avec nos clients et les fabricants de valeur. Aujourd'hui avec des partenaires en Amérique du Nord, Europe, Asie et Amérique du Sud, nous travaillons continuellement à améliorer et développer l'entreprise. Nous nous efforçons d'offrir à nos clients une valeur exceptionnelle grâce à nos ventes locales qualifiées et des représentants de service qui offrent un accès facile à plus de 6500 produits provenant du monde entier.

---

Desde 1951 Omcan ha crecido hasta convertirse en un líder en la distribución de equipos y suministros de alimentos en América del Norte industria de servicios. Nuestro éxito en estos años se puede atribuir a nuestro compromiso de fortalecer y desarrollar nuevas relaciones existentes con nuestros valiosos clientes y fabricantes. Hoy con socios de América del Norte, Europa, Asia y América del Sur, que trabajan continuamente para mejorar y crecer la empresa. Nos esforzamos por ofrecer a nuestros clientes valor excepcional a través de nuestro local de ventas y representantes de los servicios que proporcionan un fácil acceso a más de 6,500 productos con origen a nivel mundial.

